

NOTES:
THIS DRAWING IS THE PROPERTY OF O-I AND
MUST NOT BE REPRODUCED OR DISCLOSED
WITHOUT O-I WRITTEN AUTHORIZATION.

ONLY TOLERANCED DIMENSIONS ARE GUARANTEED.

MANUFACTURING MARKINGS SHOWN ARE FOR ILLUSTRATIVE
PURPOSES ONLY. ACTUAL MARKINGS ON CONTAINER
MAY DIFFER, DEPENDANT ON LOCAL LEGISLATION.

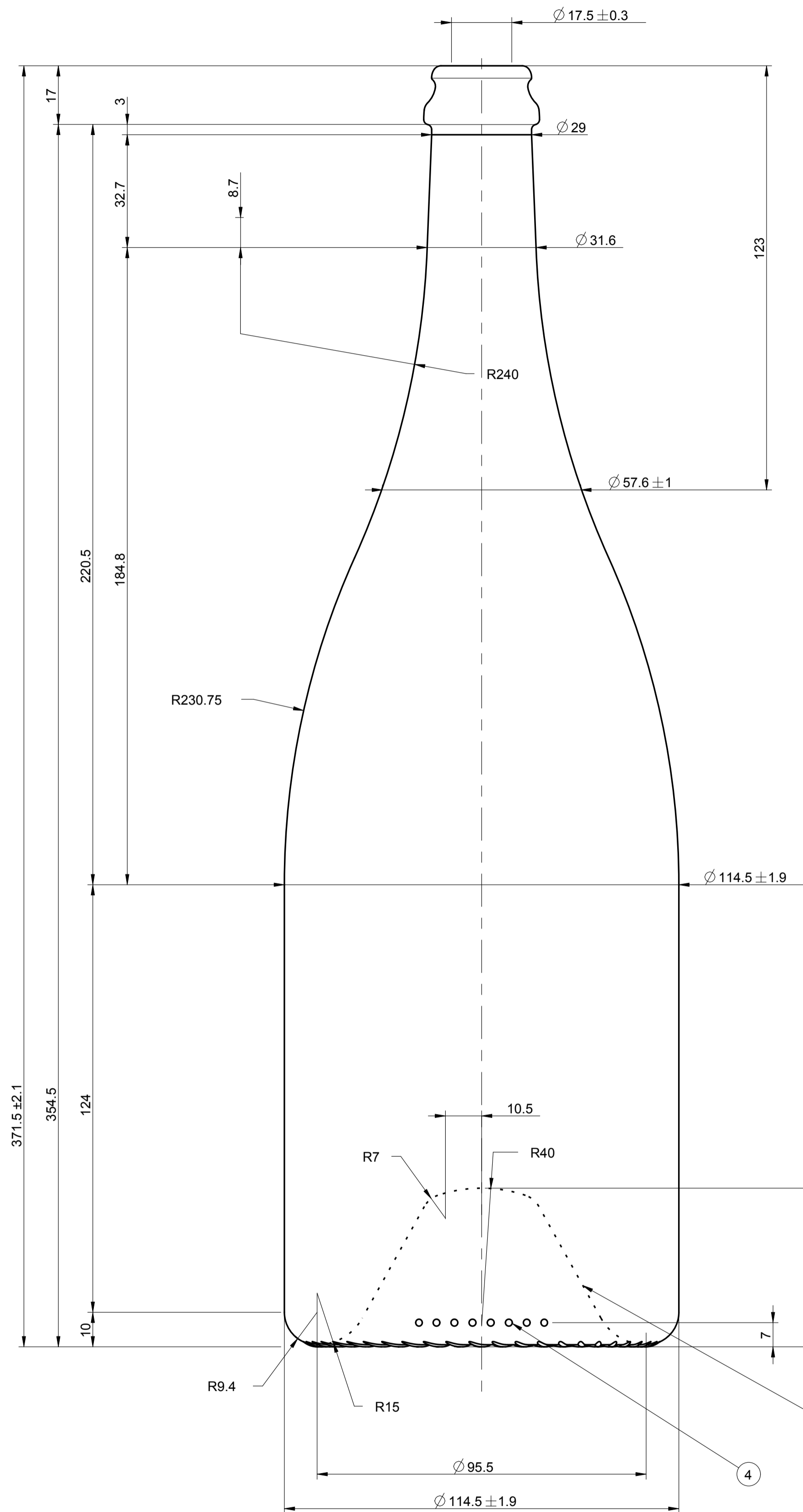

Sur une hauteur de 20mm, la pique doit être lisse, exempte de gravure pour faciliter la prise des bouteilles par ventouse

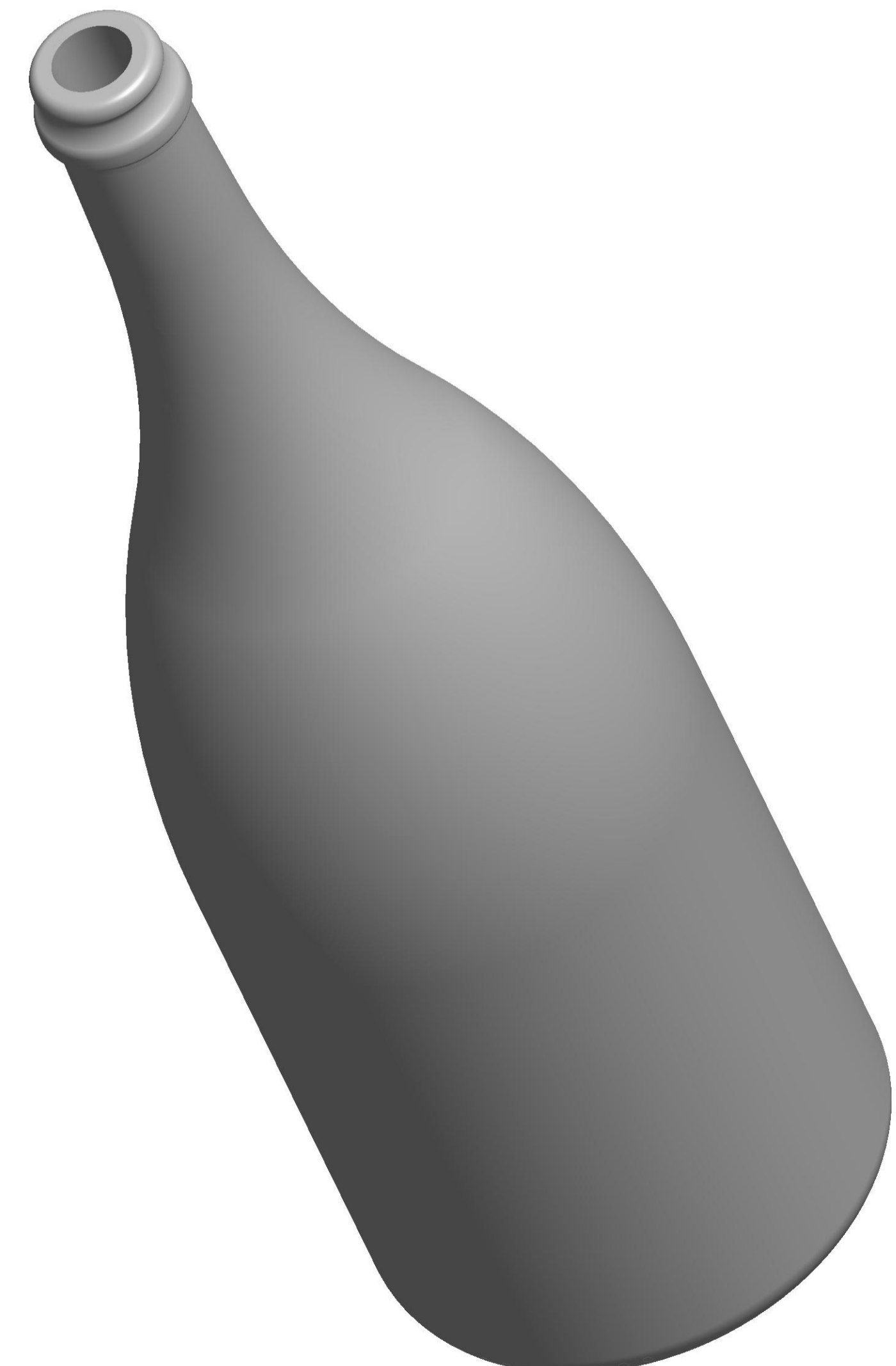
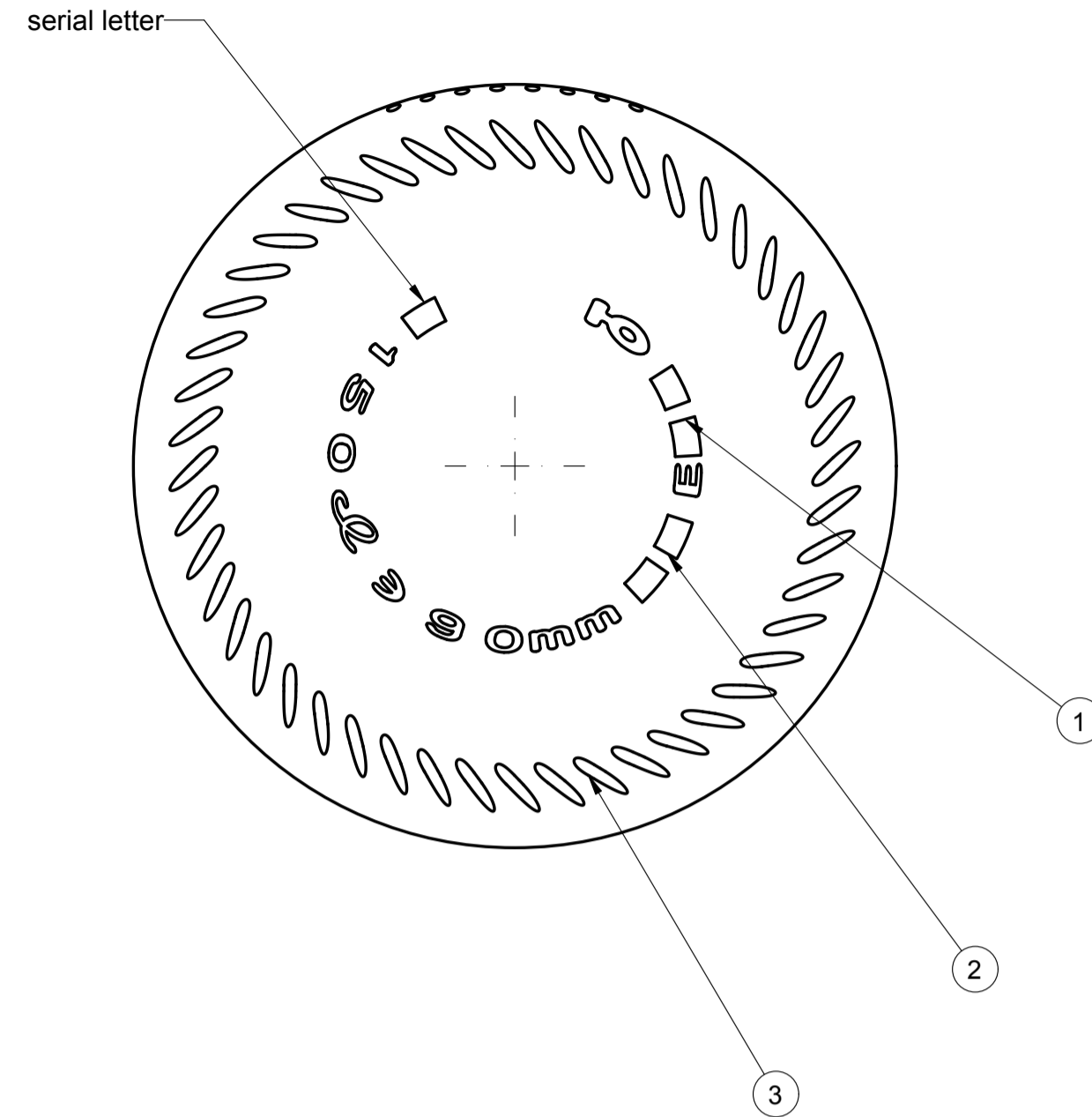

| | |
|---|----------------------------------|
| HEAT TREATMENT 20 °C maxi | CARBONATION 13 g CO2/l maxi |
| VERTICAL LOAD 500 daN maxi | THERMAL SHOCK 42 °C maxi |
| CATEGORY WINE | TILT ANGLE 22.33 |
| MAX. VERTICALITY TOLERANCE 4.0 mm | MEASURING CONTAINER YES |
| FINISH SAP NUMBER 3589 | FINISH REF. SPECIAL |
| MINIMUM THROUGH BORE 16.5 mm | MAX FILLING TUBE Ø 15 mm |
| CONTAINER OVERFLOW CAPACITY (BRIMFUL) | |
| 1533ml APPROX. | |
| CONTAINER RATED CAPACITY (FILLPOINT) | |
| 1500ml ± 15ml | |
| CONTAINER WEIGHT | |
| 1730g APPROX. | |
| FINISH DESIGNATION FR_29_SPECIAL_H170_3589 | MAX GAS VOLUME |
| PROCESS RETURNABLE NO | DESIGN REF. Rework dr 193506D |

STANDARD
150 CL CHAMPENOISE

| | | | |
|----------|-----|------|----------|
| DESIGNER | EBL | DATE | 11/04/11 |
| CHECKED | | DATE | |

| | |
|----------------|------------------|
| DRAWING NUMBER | MOULD/SAP NUMBER |
| 110309 | 012488 |

| | | | |
|----|----------|--|--------------|
| No | DATE | REVISIONS | DESIGN/CHECK |
| | 12/04/11 | Updating in KBE drawing n°1935-06D (ex 1648/211) | EBL |

1 = TRADEMARK
2 = CAVITY No.
3 = STIPPLING
THE SHAPE OF STIPPLES IS ONLY AN
INDICATION AND THE CONSTRUCTION IS AT
THE PRODUCTION PLANT DISCRETION.
4 = CAVITY CODE