

NOTES:
THIS DRAWING IS THE PROPERTY OF O-I AND
MUST NOT BE REPRODUCED OR DISCLOSED
WITHOUT O-I WRITTEN AUTHORIZATION.

DIMENSIONS EXPRESSED IN mm
ONLY TOLERANCED DIMENSIONS ARE GUARANTEED.

MANUFACTURING MARKINGS SHOWN ARE FOR ILLUSTRATIVE
PURPOSES ONLY. ACTUAL MARKINGS ON CONTAINER
MAY DIFFER, DEPENDANT ON LOCAL LEGISLATION.

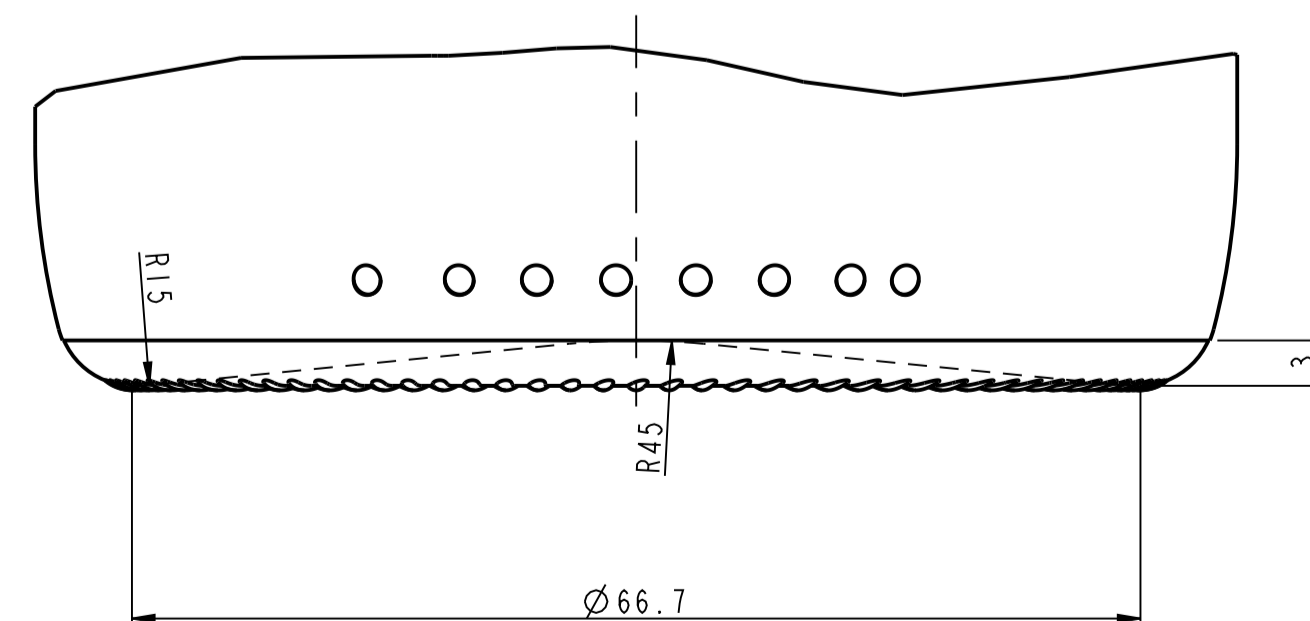
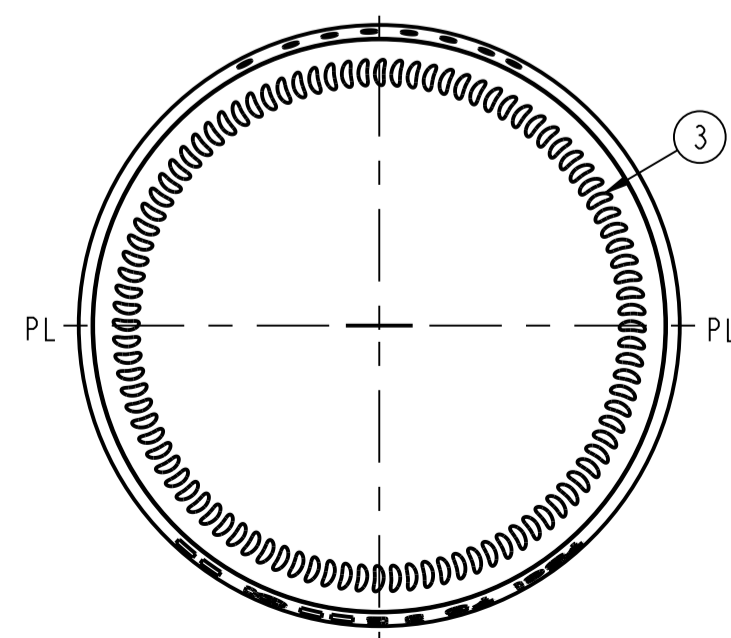
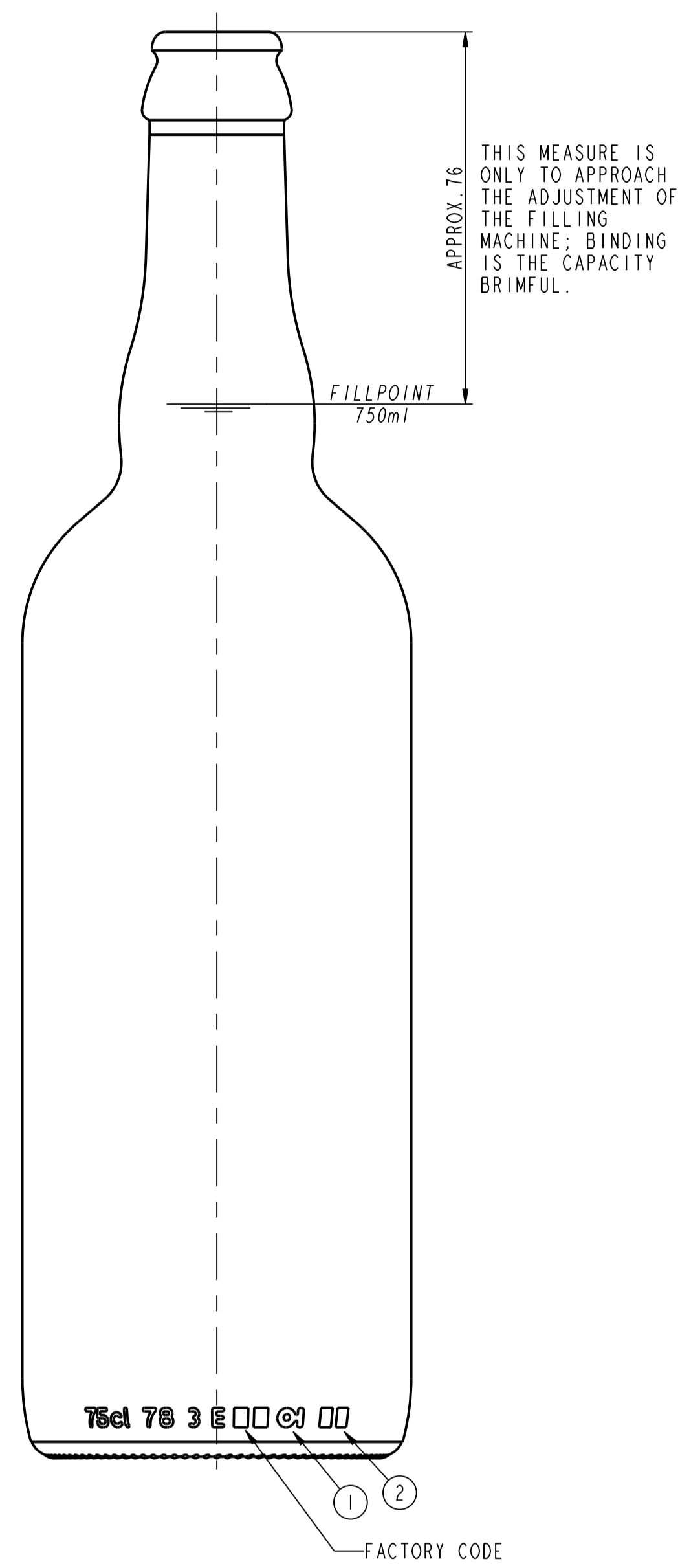
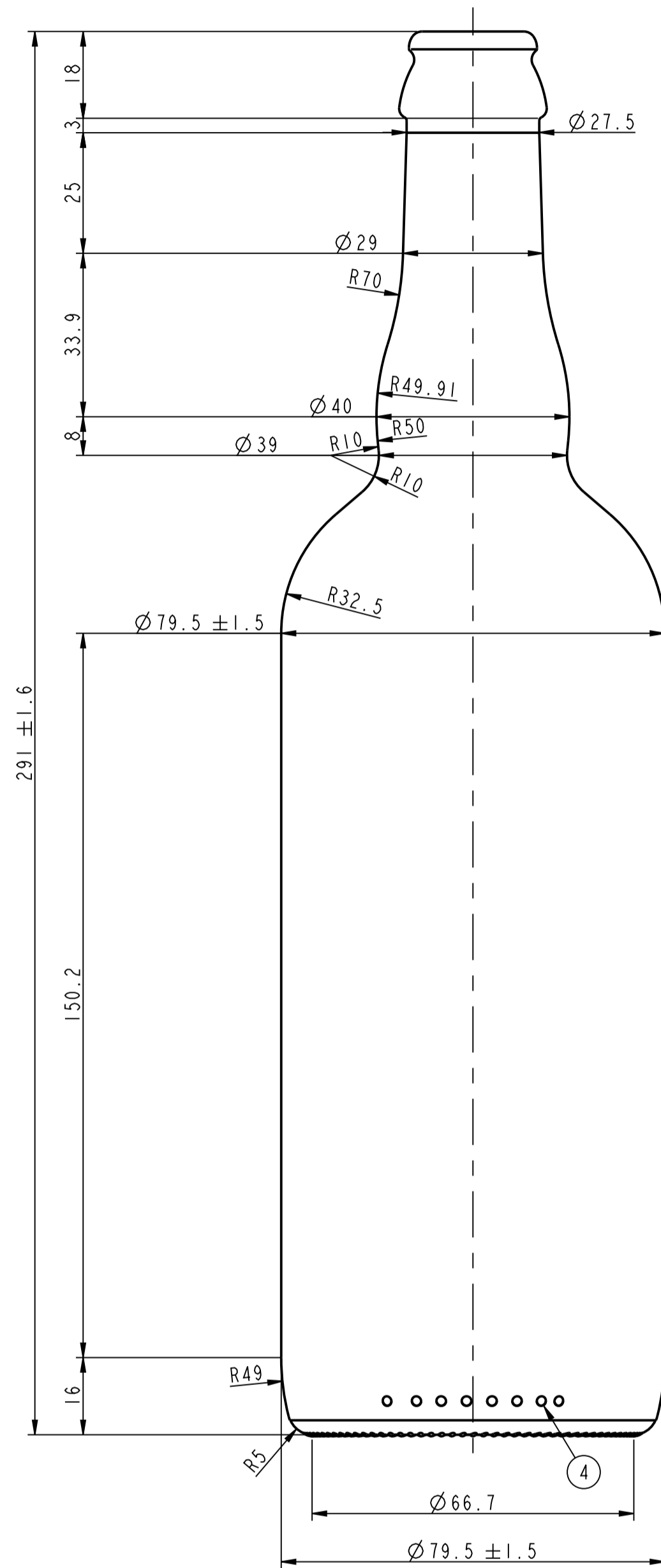

PUSH-UP CONSTRUCTION
SCALE 2/1

1 = TRADEMARK
2 = CAVITY No.
3 = STIPPLING
THE SHAPE OF STIPPLES IS ONLY AN
INDICATION AND THE CONSTRUCTION IS AT
THE PRODUCTION PLANT DISCRETION.
4 = CAVITY CODE

SCALE 1:1

CATEGORY BEER	TLT ANGLE 18.16°
MAX. VERTICALITY TOLERANCE 3.2 mm	MEASURING CONTAINER YES
FINISH SAP NUMBER 7603	FINISH REF. SPECIAL
MINIMUM THROUGH BORE 16.0 mm	MAX FILLING TUBE Ø 1.5 mm
CONTAINER OVERFLOW CAPACITY (BRIMFUL) 780ml ± 10ml	
CONTAINER RATED CAPACITY (FILLPOINT) 750ml	
CONTAINER WEIGHT 565g APPROX.	
FINISH DESIGNATION DE-26-SPECIAL-H180-7603	MAX GAS VOLUME 8g CO2/l
PROCESS B&B	RETURNABLE YES
	DESIGN REF. EU 8374
Maisel 750ml Bier Belgien	
DESIGNER B.S.	DATE 20.11.2013
CHECKED	DATE
DRAWING NUMBER 131126	MOULD/SAP NUMBER 131126

No	DATE	TENTATIVE REMOVED REVISIONS	DESIGN/CHECK
----	------	--------------------------------	--------------